

Desert Bloom

Open 2026 at Remuda Park



PRESENTED BY



EVERYTHING GRAPHIC DESIGN
Jersey Design | Branding & Logos | Web Design | Digital Art



TOURNAMENT CONTACT

Contact the tournament director with any questions.

Derek Warner
602-882-8296

Scott Oxspring
602-247-0706

INFO + SCHEDULE

The Desert Bloom Open is a 1-round PDGA Sanctioned C-Tier shotgun start tournament.

The course is **cart friendly** and a **bathroom** is available at the residential location by tournament central.

Amateur Player Packs include a custom drink glass or umbrella.

Amateur Winners can order the tournament jersey free of charge (customization included). **Pro Winners** will receive 100% payout.

Saturday, April 25, 2026

6:30-6:55am Check-in at tournament central.

6:55-7:00am Brief players meeting.

7:05am-9:00pm Round 1 - Shotgun start.

9:00am-9:20pm Award ceremony - pack up baskets.

REMUDA PARK PRIVATE DISC GOLF COURSE

13328 W Remuda Dr
Peoria, AZ 85383

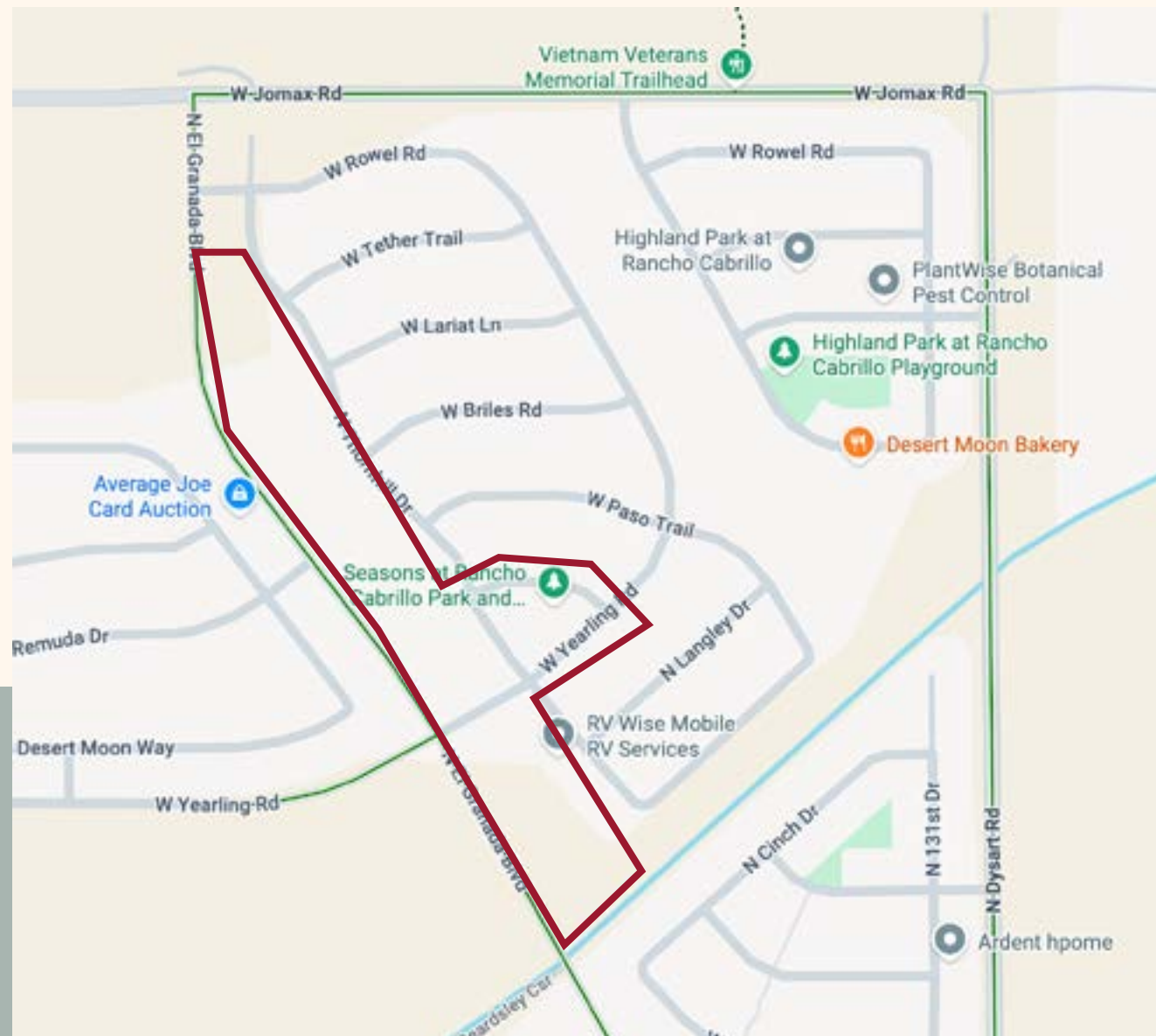

PARKING

DO NOT BLOCK DRIVEWAYS and park on the park side only. Please park in coordination with the lines in the image below. You may be asked to move if you are blocking any tee pads.

Tournament Central is indicated as a circle, located in the residential driveway.





All Division

Grass is inbounds. If disc is not touching or in the grass, OB. Play from last inbounds +1. If your tee shot does not cross inbounds, re-tee +1.

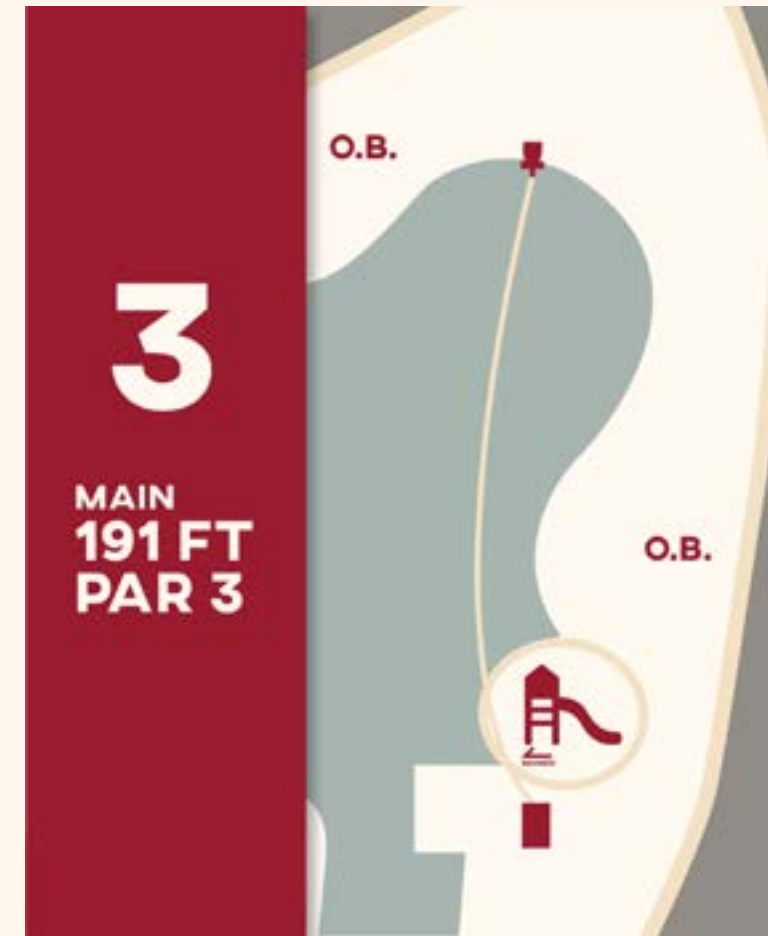

All Division

Grass is inbounds. If disc is not touching or in the grass, OB. Play from last inbounds +1. If your tee shot does not cross inbounds, re-tee +1. Mandatory left of playground structure. If missed, re-tee +1.



All Division

Grass is inbounds. If disc is not touching or in the grass, OB. Play from last inbounds +1. If your tee shot does not cross inbounds, re-tee +1.

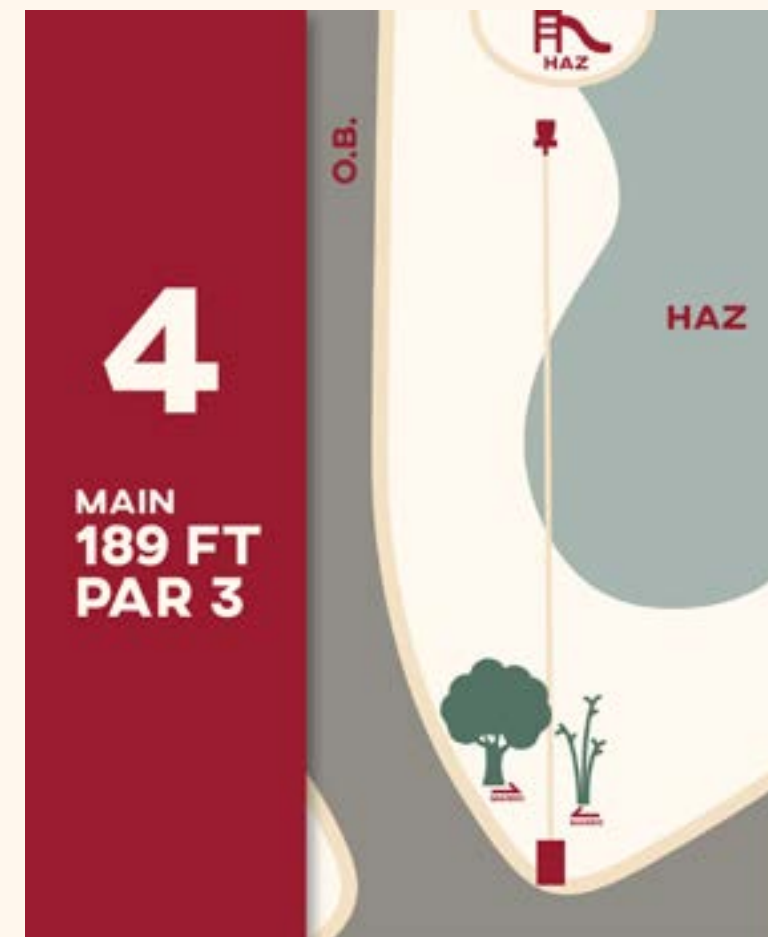

All Division

Double mando between large left tree & pokey right tree. If missed, re-tee +1. Rocks/pavers inbounds. Sidewalk/cement & beyond OB. Play from last inbounds +1. Woodchips & grass hazard. Play from where you land +1.



All Division

Grass is inbounds. If disc is not touching or in the grass, OB. Play from last inbounds +1. If your tee shot does not cross inbounds, re-tee +1.



All Divisions

Grass is inbounds. If disc is not touching or in the grass, OB. Play from last inbounds +1. If your tee shot does not cross inbounds, re-tee +1.



All Division

Grass is inbounds. If disc is not touching or in the grass, OB. Play from last inbounds +1. If your tee shot does not cross inbounds, re-tee +1.



All Division

Grass is inbounds. If disc is not touching or in the grass, OB. Play from last inbounds +1. If your tee shot does not cross inbounds, re-tee +1.



All Division
 Rocks/pavers inbounds. Sidewalk/
 cement & beyond OB. Play from
 last inbounds +1. Woodchips & grass
 hazard. Play from where you land +1.



All Division
 Wall and beyond OB. Sidewalk and
 beyond OB. Play from last inbounds +1.

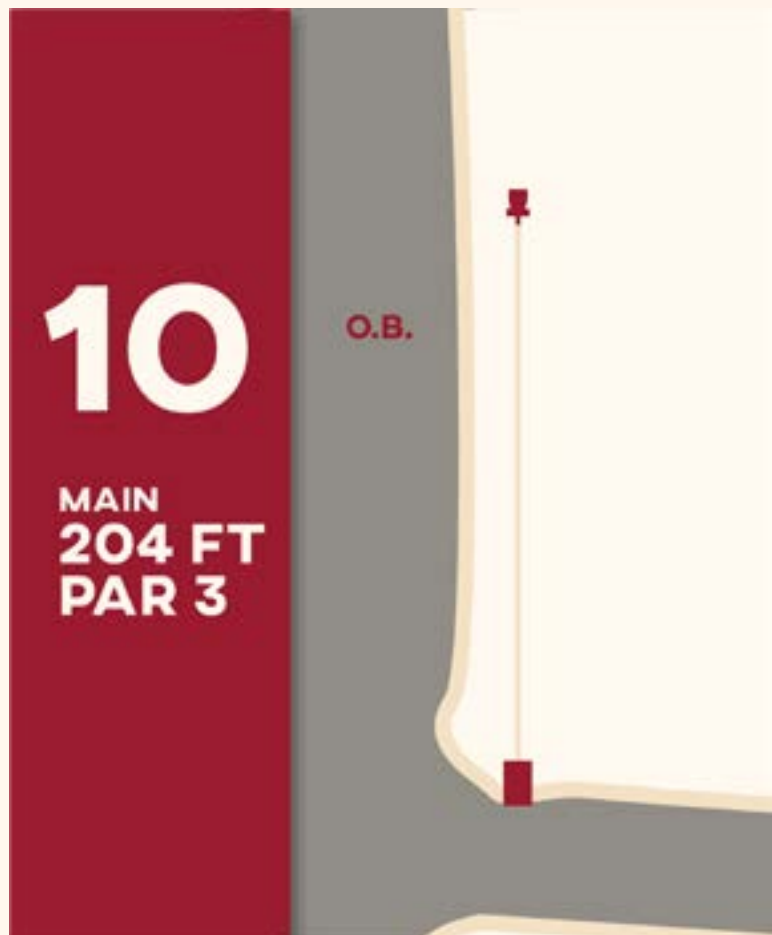

All Division
 Wall and beyond OB. Sidewalk and
 beyond OB. Play from last inbounds +1.



All Division
 Wall and beyond OB. Sidewalk and
 beyond OB. Play from last inbounds +1.



All Division
Wall and beyond OB. Sidewalk and beyond OB. Play from last inbounds +1.



All Division
Wall and beyond OB. Sidewalk and beyond OB. Play from last inbounds +1.



All Division
Wall and beyond OB. Sidewalk and beyond OB. Play from last inbounds +1.



All Division
Sidewalk and beyond OB. Large rocks covered by wire OB. Drainage area OB. Disc must land in small gravel area where basket is placed.

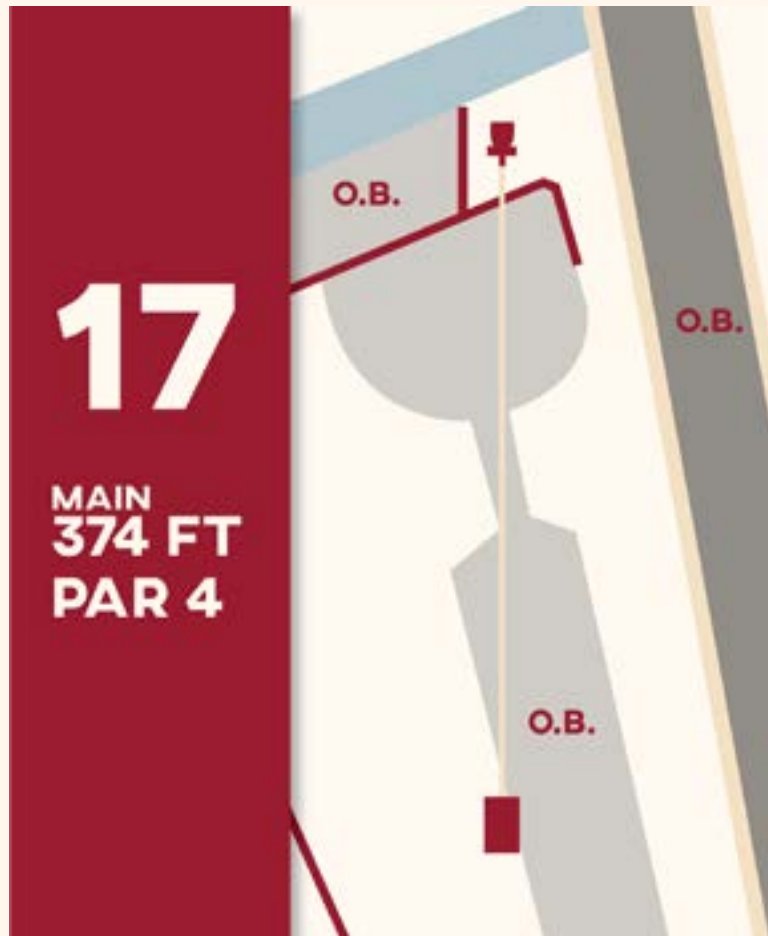

All Division

Wall and beyond OB. Sidewalk and beyond OB. Large gray/dark rocks covered by wiring OB. Play from last inbounds +1.



All Division

Sidewalk and beyond OB. Gutter with rocks in fairway is OB. Play from last inbounds +1. Rocks covered by wiring plays as hazard. Play from where disc lands +1.



DONATIONS

The next step in the Coldwater Disc Golf re-design is getting concrete tee pads and new signage. There is a go-fund me page dedicated to reaching these goals (100% of donations will go towards signs and tee-pads). We appreciate any financial help you are willing to offer to make a great local course for us all!

The QR code below will take you to the Go-Fund Me page for the Coldwater Disc Golf course.

<https://gofund.me/2dec32e8c>



TOURNAMENT JERSEYS

All proceeds will be donated back into the Coldwater Ranch Disc Golf re-design fund for new tee-pads and signs.

This design is available for a limited time only - last day to order is May 5th. Printing and shipping will take up to 6-8 weeks after orders are processed. Please double check sizing before placing your order, there are no returns.

If you are local and want to pick-up your jersey to avoid shipping costs, apply the discount code LOCAL on your order and Derek will reach out to you to coordinate pick-up when the jerseys are in.

Armature winners will be emailed after the tournament on how to order their jerseys for free.

Use the QR code below to direct you to the order page for the tournament jersey.

<https://hhdesign.studio/shop/desert-bloom-open-2026>

